

Scanner User's Guide

plustek
Image Solution Provider



- ✓ Installation
- ✓ Usage & Maintenance



© 2004-2005. All rights are reserved. No portion of this document may be reproduced without permission. All trademarks and brand names mentioned in this publication are property of their respective owners.

While all efforts have been made to ensure the accuracy of all contents in this manual, we assume no liability for errors or omissions or by statements of any kind in this manual, whether such errors are omissions or statements resulting from negligence, accidents, or any other cause. The contents of this manual are subject to change without notice.

The scanning of certain documents, for example checks, bank notes, I.D. cards, government bonds, or public documents, may be prohibited by law and/or subject to criminal prosecution. We recommend you to be responsible and respectful of the copyrights laws when you are scanning books, magazines, journals and other materials.

The product is designed and produced to achieve sustainable environmental improvement. We strive to produce products in compliance with global environmental standards. Please consult your local authorities for proper disposal. The product packaging can be recycled.

Table of Contents

INTRODUCTION	1
How to Use This Guide	1
Conventions of This Guide	2
A Note about Icons	2
Safety Precautions.....	2
Minimum System Requirements	3
Box Contents	4
The Scanner's Features	4
CHAPTER I. INSTALLING THE SCANNER	6
Software Installation Requirements	6
Hardware Requirements.....	6
Installing and Setting up the Scanner	7
<i>Step 1. Unlock your scanner</i>	7
<i>Step 2. Connecting the scanner to Your Computer</i>	8
<i>Step 3. Installing the software</i>	8
<i>Step 4. Testing the Scanner</i>	10
Software Setup Troubleshooting	10
Installing Additional Software.....	11
Scanner Setup After Windows XP Upgrade	11
CHAPTER II. USAGE AND MAINTENANCE	12
Operating the Scanner.....	12
Scan the Image(s)	12
Scanner Buttons (Paper function).....	13
<i>Using the Scanner Buttons</i>	13
<i>Defining The Custom Button</i>	14
Status Indicator	15
Scanner Connection	15
Scanner Lock.....	16
Usage & Maintenance Tips.....	16
APPENDIX A: SPECIFICATIONS	18
APPENDIX B: CUSTOMER SERVICE AND WARRANTY	19
Statement of Limited Warranty	19
FCC Radio Frequency Statement.....	20
CONTACTING PLUSTEK	22

Introduction

Welcome to the world of Plustek scanners – the ultimate in computer imaging. Your new scanner will improve the professionalism of your day-to-day computing tasks by allowing you to input images and electronic text into your computer system.

Like all of our products, your new scanner is thoroughly tested and backed by our reputation for unsurpassed dependability and customer satisfaction.

Please remember to register your scanner. Registration may be completed in one of three ways:

- 1) By registering online via Plustek's website;
- 2) By printing out and faxing a completed registration card to Plustek's customer service center;
- 3) By printing out and mailing the registration card directly to the Plustek office nearest you.

See the last page of this user's guide for a complete list of Plustek offices worldwide.

As a registered customer, you will receive customer support, new product information and software upgrades.

Thank you for choosing us as your scanner supplier. We hope you will continue to turn to us for additional quality products as your computing needs and interests grow.

How to Use This Guide

This User's Guide provides instructions and illustrations on how to install and operate your scanner. This guide assumes the user is familiar with Microsoft Windows XP, 98, Me and 2000 Professional. If this is not the case, we suggest you learn more about Microsoft Windows by referring to your Microsoft Windows manual before using your scanner.

The Introduction section of this manual describes the box contents and minimum computer requirements to use this scanner. Before you start installing your scanner, check the box contents to make sure all parts are included. If any items are damaged or missing, please contact the vendor where you purchased your scanner or our customer service directly.

Chapter I describes how to install scanner's software and connect the scanner to your computer. Note: The scanner connects to your computer through the Universal Serial Bus (USB). If your computer does not support USB technology, you will need to purchase a USB interface card to add USB capabilities to your computer, or buy and install USB connectors if your motherboard has USB capabilities. This guide assumes that your computer is USB-ready and has a free USB port.

Chapter II describes how to use, maintain and clean your scanner.

Appendix A contains the Specifications of the scanner you purchased.

Appendix B contains our limited warranty agreement and FCC statement concerning the product.

Conventions of This Guide

[XXX] — Represents commands or contents on your computer screen

Italic — First use of an important term in a chapter.

Bold — Represents buttons on your scanner OR important notes.

A Note about Icons

This guide uses the following icons to point out information that deserves special attention.



Warning

Warning: A procedure that must be followed carefully to prevent injury, or accidents.



Attention

Attention: Instructions that are important to remember and may prevent mistakes.



Information

Information: Optional tips for your reference.

Safety Precautions

Before using this device, please read the following important information to eliminate or reduce any possibility of causing damage and personal injury.

1. Moisture condensation may occur inside this device and cause malfunction at these conditions:

- when this device is moved directly from a cold to a warm location;
- after a cold room is heated;
- when this device is placed in a damp room.

To avoid the moisture condensation, you are recommended to follow the procedure:

- i. Seal this device in a plastic bag for it to adapt to room conditions.

- ii. Wait for 1-2 hours before removing this device from the bag.
2. Do not use the power adapter and USB cable provided with the scanner. Use of other power adapter and cables may lead to malfunction.
3. Keep the space around the AC adapter clear in case you need to quickly unplug the AC adapter during emergencies.
4. Damaged wire could cause fire or electrical shock. Keep the power cord straight and without being twisted, bended, or scraped.
5. Unplug this device if you don't need to use for a certain period of time, such as, during night or long weekend, to avoid any risks of causing fire.
6. Do not attempt to disassemble the scanner. There is danger of an electrical shock and opening your scanner will void your warranty.
7. Be sure not to bump or knock the scanner glass as it is fragile and could break.

Minimum System Requirements¹

- PC with Intel Pentium®II 233 MHz processor or compatible
- 128MB RAM
- Available USB 1.1 or 2.0 port
- CD-ROM Drive or DVD-ROM Drive
- 800 MB Free Hard Disk Space
- Video card that supports 16-bit color or greater
- Operating System:

USB 1.1: Windows 98, 2000 Professional, Me or XP Home Edition/XP Professional

USB 2.0: Windows 2000 Professional, or Windows XP Home Edition/XP Professional.



Information

Systems with Pentium III 500 MHz or higher processor (or its compatible), 256 MB RAM, available USB 2.0 port and 800MB free hard disk space are recommended for optimal performance.

¹ Higher requirements might be needed when scanning or editing a large quantity of image data. The system requirements here are only a guideline, as in general the better the computer (motherboard, processor, hard disk, RAM, video graphic card), the better the results.

Box Contents²

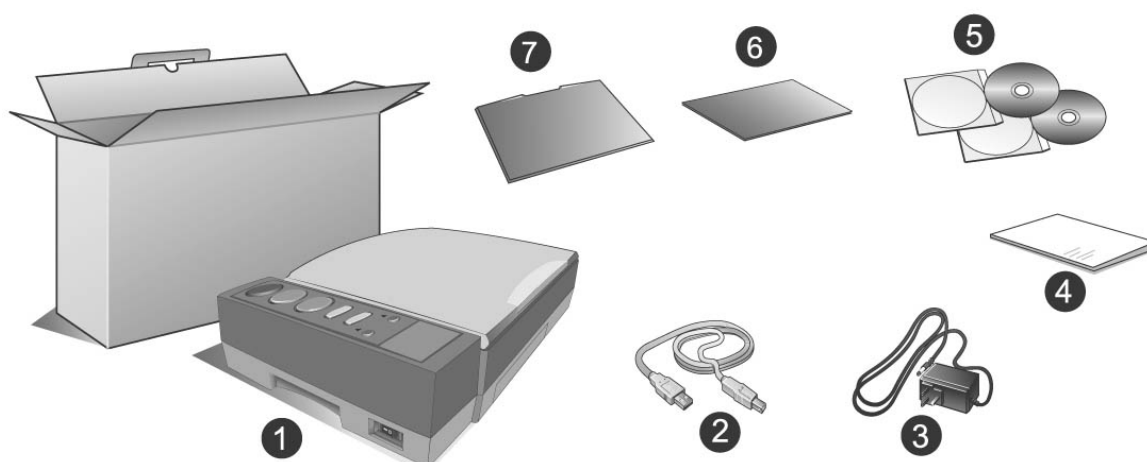

1. Scanner
2. USB cable
3. Power Adapter
4. Quick Guide
5. Set up/Application CD-ROM
6. Image Enhancement Backing (Packed under the document cover with Reflective Document Mat)
7. Reflective Document Mat

The Scanner's Features

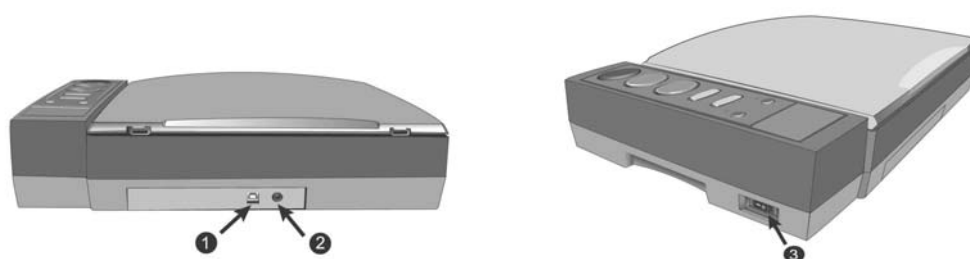

1. *USB Port*: It connects the scanner to a USB port on your computer by the included USB cable.
2. *Power Receptor*: It connects the scanner to a standard AC power outlet by the included power adapter.
3. *Power Switch*: Use this to turn the scanner ON or OFF.

² Save the box and packing materials in case you need to transport this scanner in the future. The product packaging can be recycled.

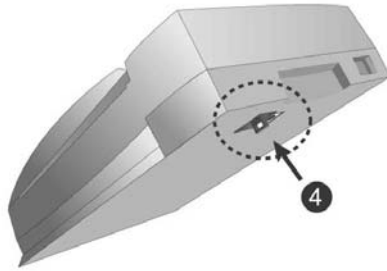

4. *Scanner Lock*: It holds your scanner head in place during transportation.

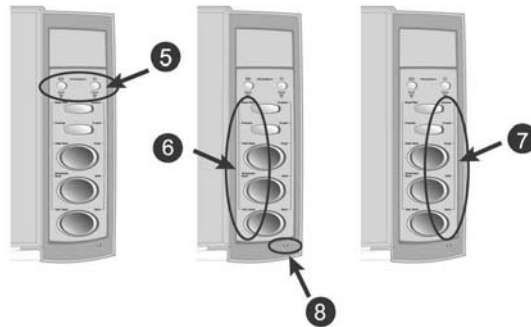

5. *Function Switch buttons & LEDs*: Corresponding to the Book or Paper button you press, the LED indicates the current function.

6. *Book function buttons*: When you press Book function button, the triangle LED below is illuminated and the buttons on the scanner panel perform functions (Book Pilot, Preview, Color Scan, Grayscale Scan and Text Scan) on this side.

7. *Paper function buttons*: When you press Paper function button, the triangle LED below is illuminated and then buttons on the scanner panel perform functions (Custom, E-mail, Copy, OCR and Scan) on this side.

8. *Power LED*: It indicates the scanner status.

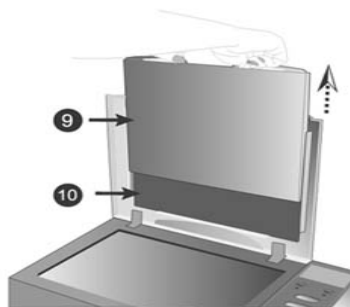

9. *Reflective Document Mat³*: Use this two-sided mat (black and white) as the background color of the to-be-scanned image.

10. *Image Enhancement Backing⁴*: Use this backing when you have “see through” problem.

³ Please refer to the FAQ document in the Setup/Application CD-ROM for further information.

⁴ Please refer to the FAQ document in the Setup/Application CD-ROM for further information. To prevent the lost of Image Enhancement Backing, make sure to replace it to the underside of the scanner document cover after use.

Chapter I. Installing the Scanner

Before installing your scanner, please verify that you have all of the proper components. A list of the package contents is provided in the *Box Contents* section of this guide.

Software Installation Requirements

Your scanner comes with the image-editing software (Ulead PhotoImpact), OCR software (FineReader), document management software (Presto! PageManager), the scanner's driver, and the Action Express software. All of these software applications use approximately 800 megabytes of hard disk space after they are installed into your computer.

The USB scanner can only operate under the Microsoft Windows 98, Me, 2000 Professional or XP operating system.



Attention

- This scanner is designed and manufactured strictly in compliance with USB 2.0 High Speed and Full Speed specifications. Should you encounter scanning problems with this scanner on Windows 98/Me whereas you have also recently upgraded the computer hardware to include USB 2.0 High Speed support, it is very probably resulted from the compatibility between the operating system and the USB 2.0 chipset on mother boards or interface cards due to Microsoft's lack of USB 2.0 support in Windows 98/Me To rectify the problem, you are recommended to buy an additional compatible card or upgrade your operating system to Windows XP/2000.
- Please do not use multiple USB scanners in Windows XP simultaneously! For more information, please refer to the following
URL...<http://support.microsoft.com/default.aspx?scid=kb;en-us:324756>

Hardware Requirements

This scanner connects to your computer through the Universal Serial Bus (USB) which supports *hot Plug and Play*. To determine whether your computer is USB-capable, you must check the rear of your PC to locate a USB jack that looks the same

as the one pictured below. Note that on some computers, the USB port at the rear of the computer may be occupied and additional ports may be found on the monitor or keyboard. If you are having trouble in locating the USB port on your computer, please refer to the hardware manual that came with your computer.

Upon examination, you should find one or two rectangular USB ports, which usually appear as shown below.

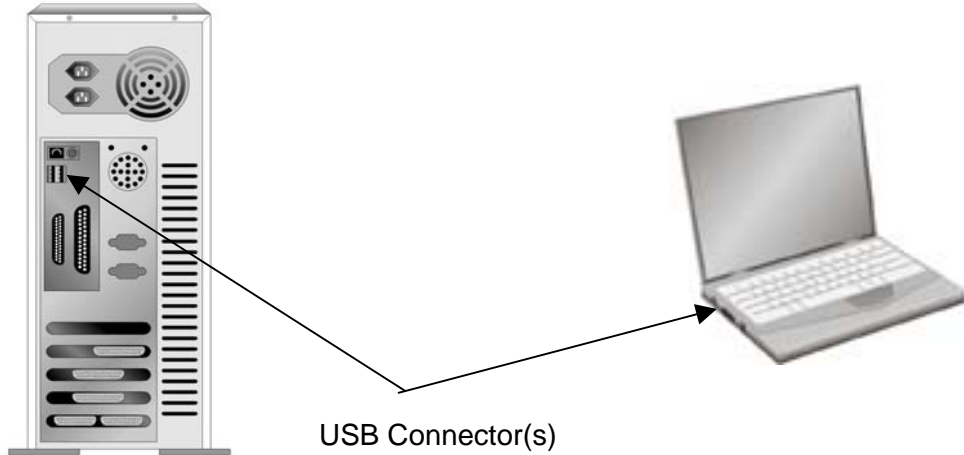

If you don't find such USB ports on your computer, then you need to purchase a certified USB interface card to add USB capabilities to your computer.

Installing and Setting up the Scanner

Please follow the step-by-step procedures described below to install the Plustek scanner.

Step 1. Unlock your scanner

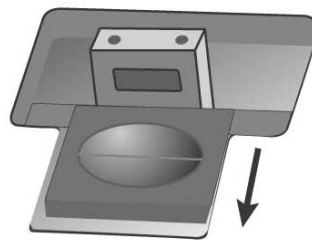

Before you connect your scanner with the computer, ensure to unlock your scanner first.

Step 2. Connecting the scanner to Your Computer

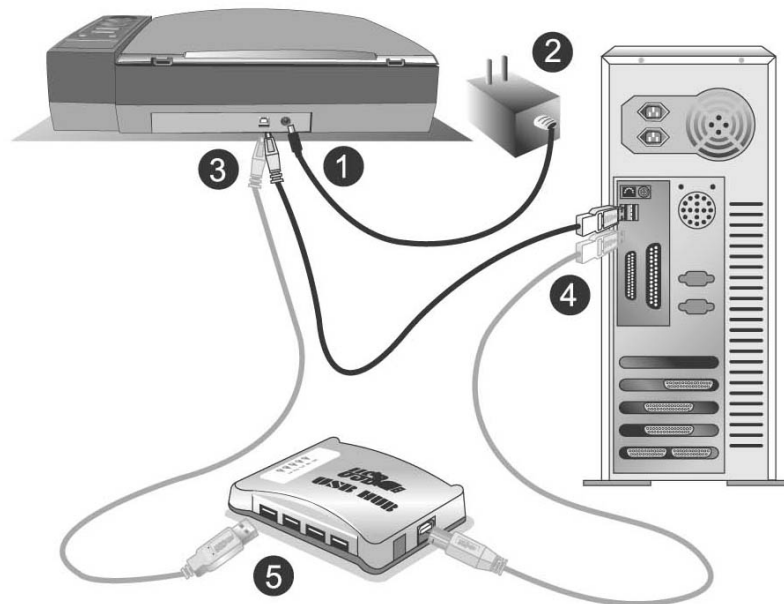

1. Plug the power adapter into the scanner's power receptor.
2. Plug the other end of the power adapter into a standard AC power outlet.
3. Plug the square end of the included USB cable to the USB port at the rear of the scanner.
4. Plug the rectangular end of the USB cable to an available USB port on the back of your computer.
5. If you plan to connect your scanner to a USB hub⁵, make sure that the hub is connected to the USB port in your computer. Next, connect the scanner to the USB hub.

Step 3. Installing the software

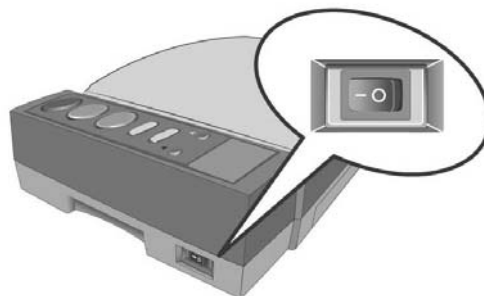

1. Switch the scanner power on.

⁵ The USB hub is not included with the scanner.

2. If the USB components on your computer are functioning correctly, they will automatically detect the scanner causing the **Add New Hardware Wizard** or **Found New Hardware Wizard** to be launched.



Information

If your computer was off when you connected the scanner, the “Add New Hardware Wizard” message will be displayed when you turn the computer on and when Windows starts.

3. **For Windows 98 & 2000**

- a. Click on the **Next** button when the “Add New Hardware Wizard” window is displayed.
- b. Select “SEARCH FOR THE BEST DRIVER FOR YOUR DEVICE [RECOMMENDED]” and click on the **Next** button.
- c. The next window will ask you where to search to find the drive. Select **CD-ROM drive**, and deselect **Floppy disk drives** if it is checked.



- d. Insert the Setup/Application CD-ROM, included with your scanner, into your CD-ROM drive and then click on the **Next** button.
- e. Click on the **Next** button in the window that appears. Afterwards, for Windows 98 users, please skip to Step 4.
- f. **Windows 2000 users** – During the process of the installation, a message “Digital Signature required” might be prompted. Please ignore it, and click on **Yes** to continue the installation without any misgiving at your scanner functioning. Afterwards, please skip to Step 4.

4. **For Windows XP & Me**

- a. Insert the Setup/Application CD-ROM, included with your scanner, into your CD-ROM drive.
 - b. Select **Install the software automatically recommended** and click on the **Next** button.
 - c. Click on the **Next** button in the window that appears.
5. When the system completes the installation, click on the **Finish** button.
 6. Follow the on-screen instructions to install all software that your new USB scanner requires.

7. After the software is installed, close all open applications and click on the **Finish** button to restart your computer.



Information

If the scanner installation is not started and displayed automatically on the screen, click **Start**, select **Run** and type in **D:\Install** (where D: is the drive letter assigned to the CD-ROM drive of your computer.)

Step 4. Testing the Scanner

The following test procedure checks to see if the scanner is properly functioning with your computer and the scanning software. Before testing your scanner, double check to make sure that all connections are securely fastened.

To properly test your scanner, please perform the following steps:

1. Open the scanner's document cover and place a book, head toward the scanner button panel, on the scanner glass.



2. Gently close the document cover.
3. Press the [Book Pilot] button on your scanner.
4. If the image with Book Pilot Window shows up, your scanner is working properly.



Information

Please refer to Book Pilot on-line help for further information about using Book Pilot.

Software Setup Troubleshooting

Carefully review the steps outlined in this guide and the Quick Guide that accompanied your scanner.

If you are still having problems, please check that:

- You have 800MB of free space on your hard disk drive.

- The scanner is plugged in and has power.
- You are using the USB cable supplied with the scanner.
- The square end of the USB cable is plugged into the rear of the scanner.
- The rectangular end of the USB cable is plugged into the back of your computer.

If you deviated from the installation procedures defined in this manual, please unplug the USB cable from the scanner and reinstall the software from the CD-ROM. To reinstall your scanner's software, click **Start, Run**, then type **D:\Install** (where D represents the letter of your CD-ROM drive). Carefully follow all the installation instructions presented in the Setup Wizard. Reboot your computer when prompted, and plug the USB cable back into the scanner while your computer is still turned on.

Installing Additional Software

Your scanner is TWAIN compliant and functions with virtually all available TWAIN compatible software. If you purchase additional software to be used with your scanner, please make sure that it conforms to the TWAIN standard.

Scanner Setup After Windows XP Upgrade

If you plan to upgrade your operating system from Windows 98 or Me to Windows XP after having installed the scanner software, please follow the instructions below:

1. Unplug the scanner's AC power adapter from the electrical outlet.
2. Unplug the scanner's USB cable from the rear of the computer.
3. From the Windows **START** menu, click on **Programs** and then **Your scanner model name**. In the pop-up menu that opens, click on **Uninstall Plustek OpticBook 3600**. Follow the on-screen instructions to remove all the scanner software.
4. After uninstallation completes, close all open applications and click the **Finish** button to restart your computer.
5. Start installing your Windows XP upgrade software by following Microsoft's related procedures.
6. When the Windows XP upgrade is done, re-install the scanner's hardware and software. Refer to the scanner setup quick guide for details.

Chapter II. Usage and Maintenance

Operating the Scanner

There are two different ways to operate the scanner:

1. From within an image-editing program that can acquire images from the scanner.
2. By using the Action Express program that is automatically installed as your scanner software.

Your scanner needs to be driven by some type of software program. Since all documents or images (whether text or pictures) that are acquired from the scanner are treated by your computer as images, most scanning will probably be done from an image-editing program where you can view, edit, save and output the scanned images. An image-editing program has been bundled with your scanner on the included Setup/Application CD-ROM. It will allow you to alter and correct any scanned images by using a variety of filters, tools and effects.

What about scanning text documents and editing them in a word processor? This is the role of Optical Character Recognition (OCR) software. OCR software converts the image files that are created from scanning text documents into text files that can be viewed, edited and saved by word processors. An OCR program has also been bundled on the included Setup/Application CD-ROM, and if you wish to use the scanner in this way you should install the OCR software that is included.

Action Express is a program that allows you to conveniently scan images and text without the need to work directly within any image-editing application (i.e. Ulead PhotoImpact). Action Express also includes features to allow you to use your scanner as a copy machine⁶ and to scan documents or photos for e-mail.

Please refer to the Action Express on-line Help for more information about these functions.

Scan the Image(s)

The following describes how you may use our bundled image-editing application *Ulead PhotoImpact XL SE*⁷ to perform your first scan. When you get familiar with the scanning, you may alternatively use other TWAIN compatible scanning program or image-editing application to do your scanning projects.

⁶ A printer is required for the copy function.

⁷ For more information about using Ulead PhotoImpact, please consult the Ulead user's guide in the Setup/Application CD-ROM.

1. Open the document cover and place your book on the scanner glass. Align the book with the  mark on the scanner housing.
2. From Windows [Start] menu, point to [Program] and select [Ulead PhotoImpact XL SE] to launch Ulead PhotoImpact.
3. On PhotoImpact, from [File] menu, point to [Scanner] and select this scanner to launch TWAIN program.

If you have more than one scanner or other imaging devices installed on your computer, you need to set this scanner as the default scanning source before you acquire TWAIN program.



1. In PhotoImpact, from [File] menu, point to [Scanner] and choose [Select Source].
2. On the pop-up window of Select Source, choose this scanner and click on [Select] to set this scanner as the default scanning source.

-
4. The TWAIN interface (Auto Mode) shows up.
 5. Click on the [Open the Auto Scan Control Panel] button if you want to adjust resolution. Click on [Close] to save the settings and return to the TWAIN interface (Auto Scan).
 6. Click on the [Auto Scan] button. The IDEAS Technology (Intelligent Detection & EAsy Scan Technology) will scan the images automatically with optimal settings and send the scanned images to Ulead PhotoImpact.



Information

The default mode for TWAIN interface is Auto Mode, but you can also click on [Switch to Advanced Mode] to tailor scanning settings with details. Please refer to the TWAIN on-line help for further information.

Scanner Buttons (Paper function)

Using the Scanner Buttons

Your scanner is equipped with function buttons designed to make your scanning experience more convenient and efficient. Under Book Function, the buttons perform Book Pilot, Preview, Color Scan, Grayscale Scan and Text Scan. Under Paper Function, the buttons perform Copy, Custom, E-mail, OCR and Scan. There are three modes you can choose from to connect with your buttons of Paper function:

Auto Mode: The IDEAS Technology will scan the images automatically with optimal settings and send the scanned image to the post processing software. This mode offers you the most effortless scanning.

EZ Mode: If you have various scanning jobs with the same setting, this mode is recommended to achieve the efficiency.

Advanced Mode: If you want to control and tailor each scan closely matching your own needs, this mode with many available choices is recommended.

You can change the default Auto Mode by following the step-by-step procedure:

1. Right click the Action Express icon  on the Windows system tray
2. Choose **Button Configuration** from the pop-up menu.
Or, if you have opened the Action Express interface by right clicking the Action Express icon and selecting **Action Express**, just click the **Button Configuration** button on the Action Express interface.
3. On the left hand side of Button Configuration window, select the button you want to set up.
4. Check EZ mode or Advanced Mode.
5. Click **OK** or **Apply**.

For further information about using **Action Express**, please refer to the on-line help by either way:



Information

1. Clicking the Help button when you are using the program.
2. Pointing to **Program | (your scanner model name)** from Windows **Start** menu, and selecting **Action Express Help**.

Defining The Custom Button

The users may turn the Custom button on the scanner panel into a multifunctional assistant by defining it as other function that is included in the Action Express. Once the Custom button is defined, the selected function will be launched with one press on the button.

The following describes how to define your Custom button by using Button Manager in Action Express.

1. Right click the Action Express icon  on the Windows system tray and select **Button Manager** from the pop-up menu.
2. The Button Manager window will pop up.

3. Click the up and down arrows to select the Custom button.
4. Choose a desired function from the drop-down list of **Select the button function**.
5. Click **OK** to apply the setting.
6. Once you press the [Custom] button on the scanner, the defined function will be launched.



- The [Custom] button can function with the default setting “Scan”, even though you didn’t define the function by using Button Manager beforehand.
- To use the buttons, ensure you have installed the relevant software (e.g., the printer driver is required for using the copy function) beforehand.



Status Indicator

The green Power LED indicator indicates the status of the scanner, as described below:

Light	Status
On	The scanner is connected with the computer, ready to scan images.
Flashing	The scanner is busy scanning.
Off	The scanner is off, either because of disconnection with the computer, or because the computer being turned off.

Scanner Connection

The first step to take when troubleshooting connection problems with your scanner is to check all physical connections. The Action Express icon , located on the Windows system tray, indicates if the scanner software is properly launched and the scanner and computer are communicating with each other.

Appearance	Status
	The program has been successfully launched and the scanner is connected with the computer, ready to scan images.
	The scanner is not connected with the computer. Or, the scanner power is not switched on.
No Display	You have chosen to terminate the program, no matter the scanner is connected or disconnected with the computer.

Scanner Lock

Your scanner is designed with three different lock statuses to protect the optical parts. To ensure the scanner working properly, you have to choose an appropriate lock status according to the situation.

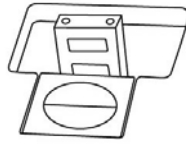

Auto Lock is for scanning on a smooth surface. The scanner will be locked automatically when the lock head is not pushed in. This lock status is recommended for general use.

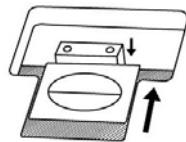

Always unlock is for scanning on a surface that is not firm, unstable or too soft. Furthermore, if you place your scanner on a long-term position, you can also keep your scanner lock in this status.



If you use this lock status, ensure to relock the scanner before any movement to prevent damage of your scanner.

Warning

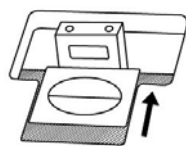

Always lock can hold the scanning head in place during transportation and traveling. The scanner will be kept in disable status.

Usage & Maintenance Tips



To keep your scanner working smoothly, take a moment to review the following usage & maintenance tips.

- Avoid using the scanner in a dusty environment. Dust particles and other foreign objects may damage the unit.
- Do not subject the scanner to excessive vibration. It may damage the internal components.

- Clean the scanner glass by lightly spraying a non-abrasive glass cleaner onto a soft lint-free cloth. Then, wipe the glass thoroughly with the cloth. DO NOT SPRAY CLEANER DIRECTLY ONTO THE SCANNER GLASS. Excess liquid residue may fog or damage the scanner.
- Your scanner operates best in temperatures between 10° C to 40° C (50° F to 104° F).

Appendix A: Specifications⁸

Plustek OpticBook 3600	
Physical dimensions	453 x 285 x 105 mm (17.83" x 11.22" x 4.13")
Weight	3.96 Kgs (8.7Lbs)
Operating Temperature	10° C to 40° C (50° F to 104° F)
Scan Area	Maximum 216 mm x 297 mm (8.5" x 11.69") Minimum 12.7 x 12.7 mm (0.5" x 0.5")
Scan Modes	Color: Input 48-bit; Output 24/48-bit Grayscale: Input 16-bit; Output 8/16-bit Black & White: 1-bit
Resolution	Optical Resolution: 1200 dpi Max. Hardware Resolution: 1200 dpi (main scan) x 2400 dpi (sub scan) Max. Interpolated Resolution: 24000 dpi
Scanning Materials	Reflective color or black-and-white originals
Protocols	TWAIN Compliant
Interface	USB 2.0 High Speed and Full-Speed mode (USB 1.1 compatible)
Lamp type	Cold Cathode Lamp
Power adapter	Power Output DC 15V, 1A
Power Consumption	Operation: 15 watts maximum Idle: 4.3 watts
EMI	FCC Class B, CE

⁸ Hardware specifications may change at any time without prior notice.

Appendix B: Customer Service and Warranty

If you encounter problems with your scanner, please review the installation instructions and troubleshooting suggestions contained in this guide.

For further assistance call our customer support phone number listed on the last page of this guide. One of our representatives will be happy to assist you from Monday through Friday in office working hours as shown below:

Europe	9:00 a.m. – 5:30 p.m. (CET)
Other Countries or Areas	9:00 a.m. – 6:00 p.m. Taiwan Time

To avoid delays, please have the following information available before calling:

- Scanner name and model number
- Scanner serial number (Located at the bottom of the scanner)
- A detailed description of the problem
- Your computer manufacturer and its model number
- The speed of your CPU (Pentium 133, etc.)
- Your current operating system and BIOS (optional)
- Name of software package(s), version or release number and manufacturer of the software
- Other USB devices installed

Statement of Limited Warranty

This Statement of Limited Warranty applies only to the options you originally purchase for your use, and not for resale, from an authorized reseller.

The manufacturer warranty includes all parts and labor, and is not valid without the receipt of original purchase. To obtain warranty service, you may contact the authorized dealer or distributor, or visit our website to check out the available service information, or send a request via E-mail for further help.

If you transfer this product to another user, warranty service is available to that user for the remainder of the warranty period. You should give your proof of purchase and this statement to that user.

We warrant that this machine will be in good working order and will conform to its functional descriptions in the documentation provided. Upon provision of proof of purchase, replacement parts assume the remaining warranty of the parts they replace.

Before presenting this product for warranty service, you must remove all programmes, data and removable storage media. Products returned without guides and software will be replaced without guides and software.

This Limited Warranty service does not provide for carry-in exchange when the problem results from accident, disaster, vandalism, misuse, abuse, unsuitable

environment, program modification, another machine or non-vendor modification for this product.

If this product is an optional feature, this Limited Warranty applies only when the feature is used in a machine for which it was designed.

If you have any questions about your Limited Warranty, contact the approved retailer from whom you bought the product or the manufacturer.

THIS LIMITED WARRANTY REPLACES ALL OTHER WARRANTIES, EXPRESS OR IMPLIED, INCLUDING, BUT NOT LIMITED TO, THE IMPLIED WARRANTIES OF MERCHANTABILITY AND FITNESS FOR A PARTICULAR PURPOSE. HOWEVER, SOME LAWS DO NOT ALLOW THE EXCLUSION OF IMPLIED WARRANTIES. IF THESE LAWS APPLY, THEN ALL EXPRESS AND IMPLIED WARRANTIES ARE LIMITED IN DURATION TO THE WARRANTY PERIOD. NO OTHER WARRANTIES APPLY AFTER THAT PERIOD.

Some jurisdictions do not allow limitations on how long an implied warranty lasts, so the above limitation may not apply.

Under no circumstances are we liable for any of the following:

1. Third party claims against you for losses or damages.
2. Loss of, or damage to, your records or data; or
3. Economic consequential damages (including lost profits or savings) or incidental damages, even if we are informed of their possibility.

Some jurisdictions do not allow the exclusion or limitations of incidental or consequential damages, so the above limitation or exclusion may not apply to you.

This Limited Warranty gives you specific legal rights, and you may also have other rights that vary from jurisdiction to jurisdiction.

FCC Radio Frequency Statement

This equipment has been tested and found to comply with the limits for a Class B digital device, pursuant to part 15 of the FCC rules. These limits are designed to provide reasonable protection against harmful interference in a residential installation.

This equipment generates, uses and can radiate radio frequency energy and, if not installed and used in accordance with the instructions, may cause harmful interference to radio communications. However, there is no guarantee that interference will not occur in a particular television reception (which can be determined by turning the equipment off and on), the user is encouraged to try to correct the interference by one or more of the following measures:

- Reorient or relocate the receiving antenna.
- Increase the separation between the equipment and receiver.

- Connect the equipment to an outlet on a circuit different from that which the receiver is connected.
- Shielded interconnect cables and shielded power cord which are supplied with this equipment must be employed with this equipment to ensure compliance with the pertinent RF emission limits governing this device.
- Consult the dealer or an experienced radio/TV technician for help if the conditions persist.
- Changes or modifications not expressly approved by the manufacturer or authorized service center could void the user's authority to operate this equipment.

Contacting Plustek

Europe

Plustek Technology GmbH
Gutenbergring 38, 22848 Norderstedt, Germany

Tel.: +49 (0) 40 523 03 130
Fax: +49 (0) 40 523 03 500
E-mail: support@plustek.de
Website: www.plustek.de

Worldwide except Europe

Plustek Inc.
13F-1, No.3 (Building F), Yuan Qu St., 115 Nankang, Taipei, Taiwan
Tel: +886-2-2655 7866
Fax: +886-2-2655 7833
Website: www.plustek.com